

# SETUP INSTRUCTIONS

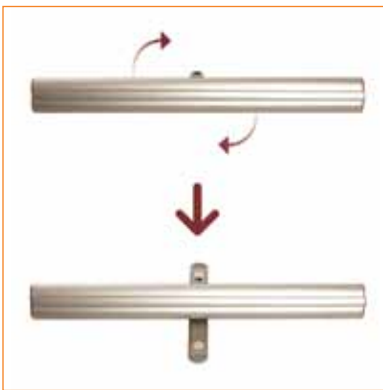

## STEP 1 - GETTIN STARTED

Unpack the banner canister, or base, and 3-sectional pole.



## STEP 2 - SPIN TO WIN

Set the base on the floor with the graphic facing away from you. Pivot the foot 90° to make the banner free standing



## STEP 3 - POLE POSITION

Unfold the pole and slip the pieces together to assemble it.



## STEP 4 - SOCKET TO THEM

With the flat tip of the pole pointing upwards, insert the bottom end into the socket at the centre of the base unit.

# SETUP INSTRUCTIONS

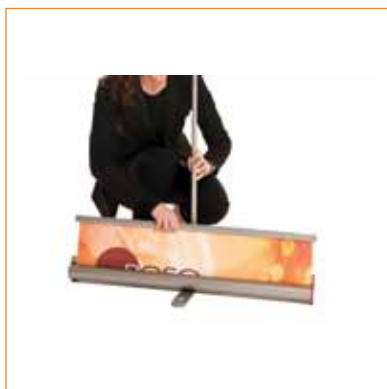

## STEP 5 - RAISE THE BAR

Extend the banner from the canister



## STEP 6 - LAID-BACK

Insert the flat tip of the pole into the rear slot of the banner beam. Tilting the unit back towards you may make it easier.