

SETUP INSTRUCTIONS

HANGING SIGN - CIRCLE



STEP 1: GETTING STARTED

Begin by removing the frame from the carry case and placing it on a clean, flat surface.

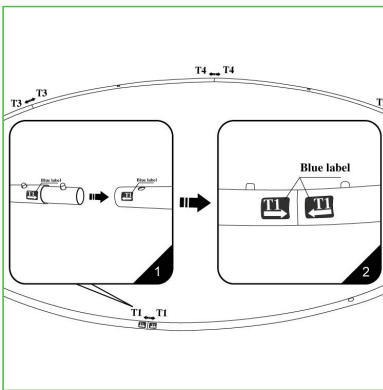

STEP 2: CONNECT THE DOTS - TOP SIDE

Assemble the top frame in order following the number diagram.

Ensure snap buttons are fully engaged for a secure connection.

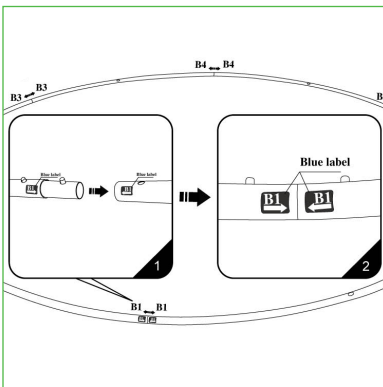

STEP 3: CONNECT THE DOTS - BOTTOM SIDE

Repeat Step 2 for the bottom frame.

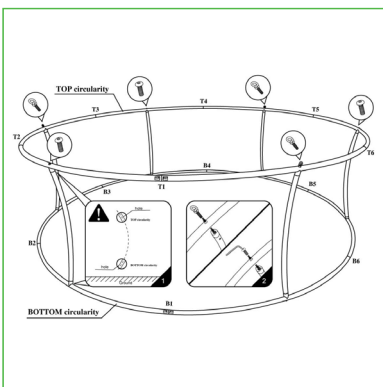

STEP 4: ADD SOME DEPTH

Add the vertical poles by attaching them to the bottom frame first.

Once all of the vertical poles are attached, lower the top frame onto the poles. Secure the top frame to the poles by alternating bolts and eyelets until the frame is secured.

SETUP INSTRUCTIONS

HANGING SIGN - CIRCLE



STEP 5: SLIP & SLIDE YOUR GRAPHIC

Lay the graphic on a clean surface and place the assembled frame on top. Pull up both sides of the graphic to the top of the frame and zipper the graphic along the top.